

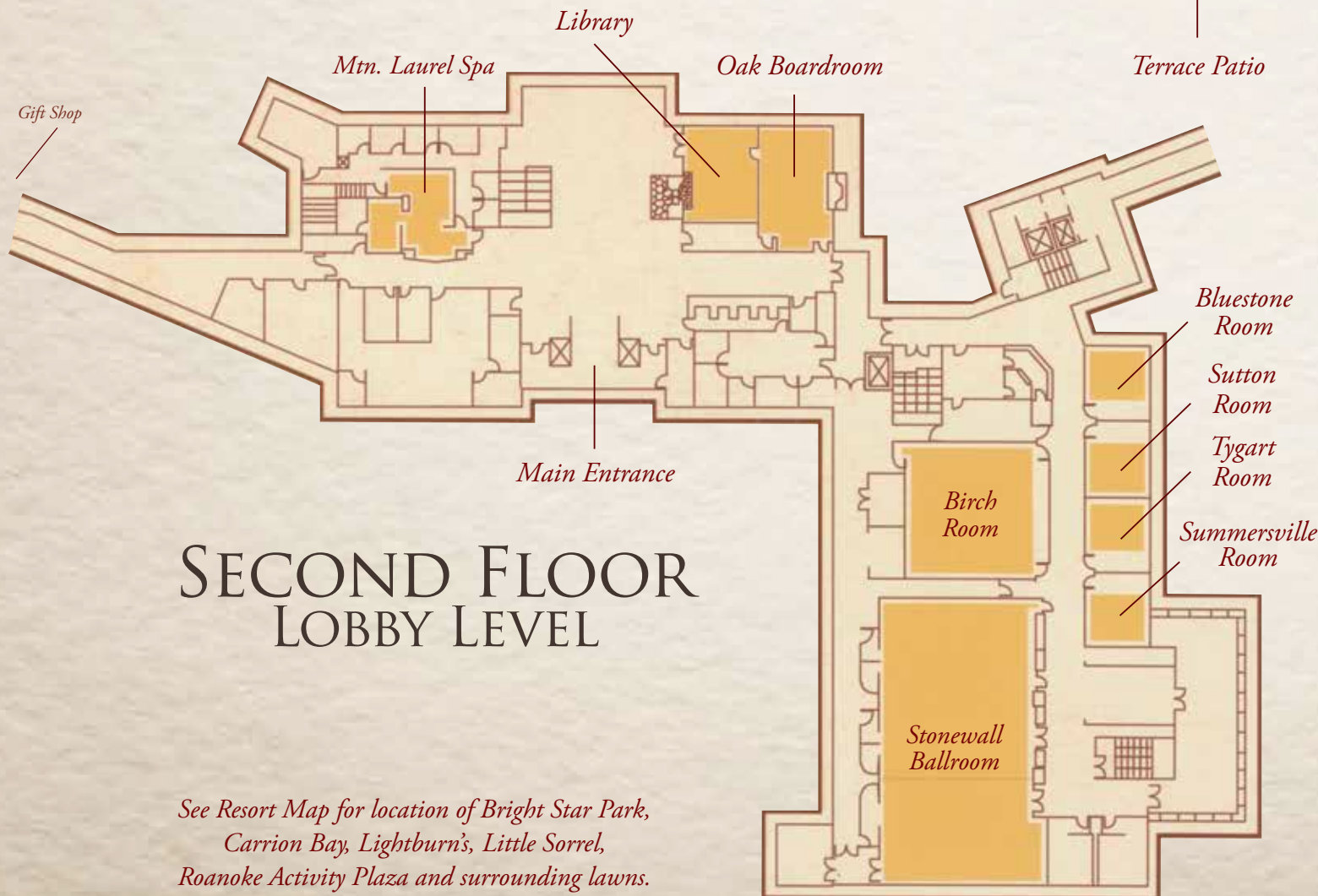

Room	Square Feet	Dimensions (Feet)	Ceiling Height (Feet)	Banquet Seating Rounds 8/10	Classroom Seating	Executive Classroom Seating	Theatre Seating	U-shape	8x10 Booths
LOBBY LEVEL									
Stonewall Ballroom	4,183	89 x 47	16	240/300	160	105	350	-	44
Stonewall Ballroom I	1,363	29 x 47	16	80/100	50	34	75	25	12
Stonewall Ballroom II	2,726	58 x 47	16	160/200	110	72	150	40	32
Oak Boardroom	759	23 x 33	14	18 conference	-	-	-	-	-
Library	616	22 x 28	10	24/30	15	10	25	9	-
Birch Room	1,848	42 x 44	13	80/100	75	50	120	35	20
Summersville Room	460	23 x 20	10	16/20	15	10	25	9	-
Tygart Room	460	23 x 20	10	16/20	15	10	25	9	-
Sutton Room	460	23 x 20	10	16/20	15	10	25	9	-
Bluestone Room	460	23 x 20	10	16/20	15	10	25	-	-
TERRACE LEVEL									
Pecan Room	1,848	42 x 44	11	80/100	75	50	120	35	20
Maple Room	896	28 x 32	11	40/50	35	20	50	17	-
Potomac Room	460	23 x 20	10	10 conference	-	-	-	-	-
Greenbrier Room	460	23 x 20	10	10 conference	-	-	-	-	-
Kanawha Room	460	23 x 20	10	10 conference	-	-	-	-	-
Gauley Room	460	23 x 20	10	10 conference	-	-	-	-	-
LIGHTBURN'S									
Restaurant	1,800	30 x 60	16	90	-	-	-	-	-
OUTSIDE SPACE									
Terrace Patio	1,080	60 x 18	12	80	-	-	80	-	-
Maple Patio	1,800	60 x 30	-	120	-	-	120	-	-
Adler Patio	2,700	90 x 30	-	160	-	-	160	-	-
Terrace Lawn	6,480	120 x 54	-	250	-	-	250	-	-
Bright Star Park Lawn	7,200	120 x 60	-	250	-	-	250	-	-
Carrion Bay Lawn	25,200	120 x 210	-	400	-	-	400	-	-
LITTLE SORREL									
Excursion Boat	-	-	8	100 reception only	-	-	-	-	-



FIRST FLOOR TERRACE LEVEL



SECOND FLOOR LOBBY LEVEL

See Resort Map for location of Bright Star Park, Carrion Bay, Lightburn's, Little Sorrel, Roanoke Activity Plaza and surrounding lawns.